

VIISAN®

VB861A

Whiteboard Camera User Guide

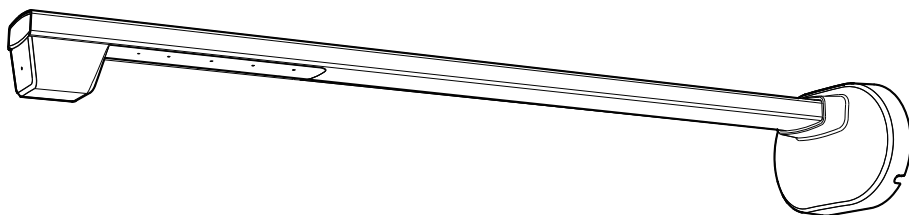

Instructions

Thank you for purchasing a VIISAN product.

This device is a whiteboard camera designed for use with an IFPD via USB connection. It features whiteboard, blackboard, and greenboard tracking, as well as presenter semi-transparency and image enhancement. This Quick Start Guide provides a brief overview of the steps to begin using your whiteboard camera. If you have any technical or service-related questions about the product, please contact our customer service team at info@viisan.com, and we will be glad to provide assistance and support.

Limited Warranty

This product provides limited warranty continues for one (1) year from the date of purchase.

Warranty Exclusions

The following circumstances excluded from warranty coverage:

- Product damage caused by catastrophes, thunder stroke, faulty electric power, and environmental factors.
- Defacing of product labeling (label alterations and falsifying, serial number missing, serial number no longer discernible, serial number invalid). All serial numbers are recorded and tracked for warranty purposes.
- Unauthorized changes of non-parts, modifications or alterations, parts removal in or to the products.
- Damage caused by operator error or operator fails to comply user manual instruction, such as, but not limited to improper storage resulting in product get wet, corroded, fell off, or squeezed or exposed to inadequate temperature/humid environment.
- Accessories or packing material such as boxes, user manual, etc.

Safety & Environmental Information

- This device complies with part 15 of the FCC rules and CE certification.
- Discarded electrical and electronic appliances are recyclable and should separate from household waste. Please actively support in conserving resources and protecting the environment by returning this appliance to the collection centers.



System Requirements

For IFPD: ARM Cortex-A55 Quad-Core or higher
For Desktop or Laptop: Intel® i5 processor or higher
USB Port: USB 2.0 or above
Memory: At least 8 GB RAM (16 GB or higher recommended)
Android™ 9.0 or later
Microsoft® Windows® 10 / 11

Specification

Max. Resolution	4K (3840 × 2160) at 30fps
F/NO	2.6
Field of View	150°
Color bit depth	24-bit
Focus	Fixed focus
Support Whiteboard Size:	Up to 200×160cm Recommended Size: 150 × 90 cm
Interface	USB-C 2.0
Video Compression	MJPG, YUY2, H264, H265
USB Cable Length	5 Meters
Power Frequency Support	50Hz / 60Hz
Power	5V / 2A (USB-C 2.0 Input with Dual USB-A Output)
Dimension	683.1 (L) x 150 (W) x 100 (H) mm
Net Weight	Approx. 0.52kg
System Requirements	Windows 10/11 Android 9.0 or later

Package Contents

Before use, please make sure the following items are included in the package.
If any item is missing, please contact the retailer from whom you purchased the product.

- 1. Whiteboard Camera
- 2. Hanging Board
- 3. KA3 Screws (30 mm × 4) – for wooden walls
- 4. KA3 Screws (40 mm × 4) – for concrete walls
- 5. Plastic Expansion Anchors × 4
- 6. USB Cable (5 Meters)
- 7. Mounting Template
- 8. Quick Start Guide

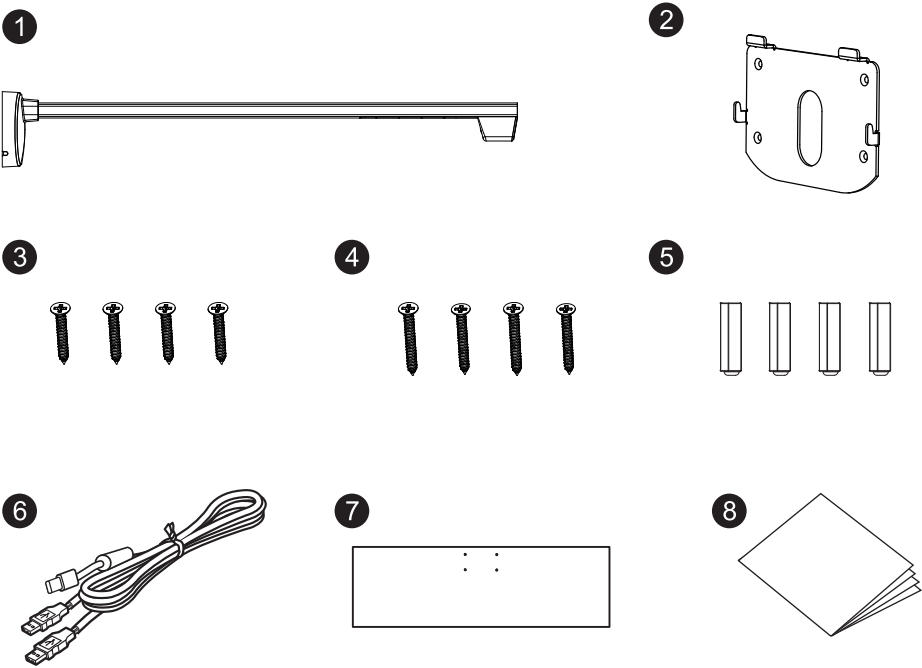

Part Description

- 1. LED Indicator
- 2. Base
- 3. Mounting Slot
- 4. USB Type-C Port
- 5. Cable Hole
- 6. Camera

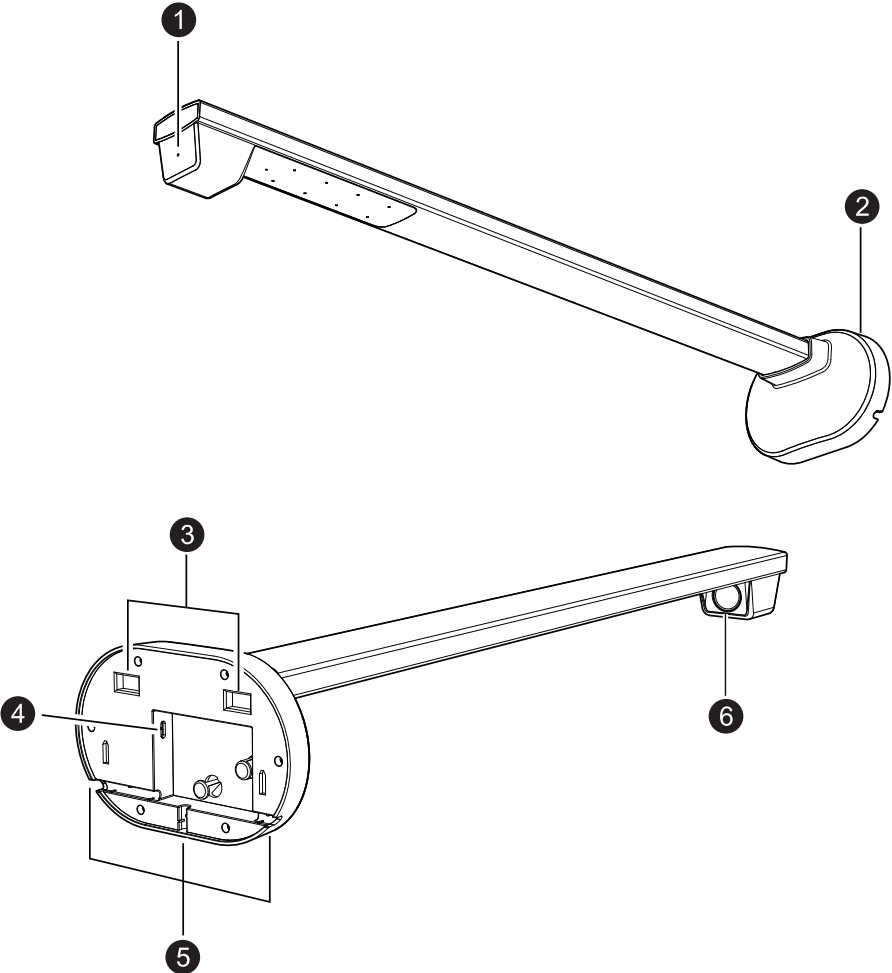

Installation Steps

Wall Mount Installation

1. Use the supplied Mounting Template from the package, place it horizontally at the top center of the whiteboard, and mark the screw hole positions with a pencil.

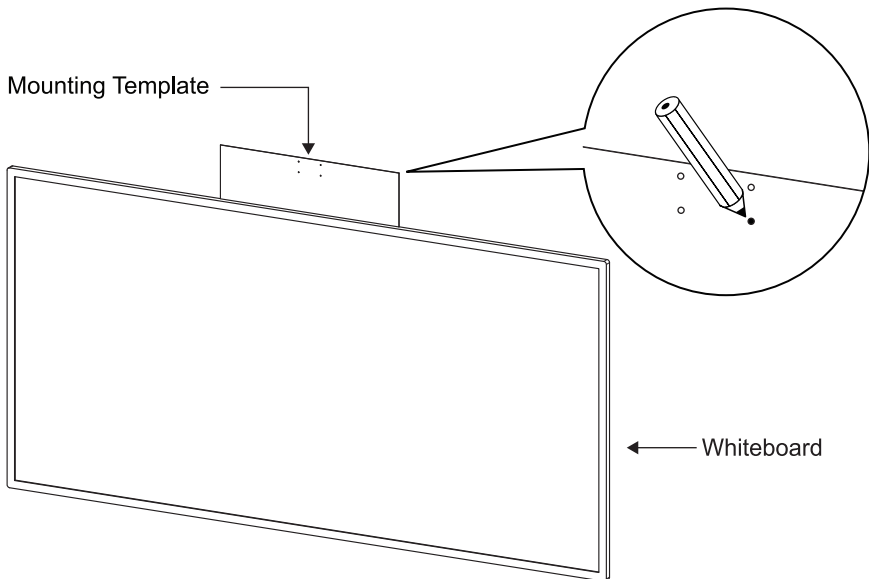

2. Insert the four plastic expansion anchors into the wall holes, then fasten the four KA3 screws.

Note: Use 30 mm screws for wooden walls and 40 mm screws for concrete walls.

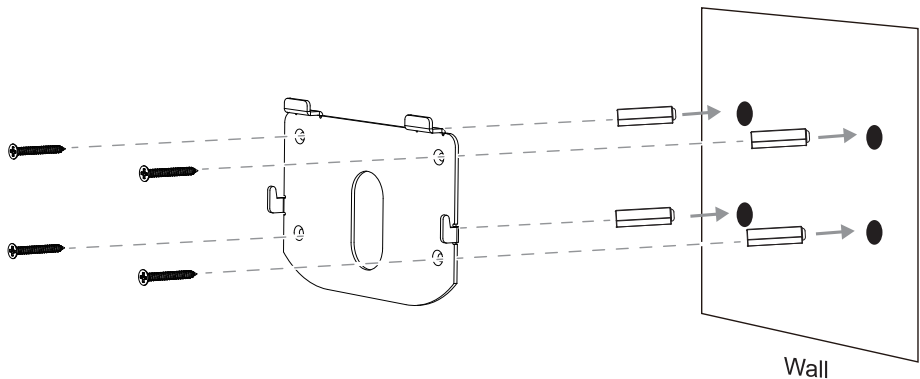

4. Plug the USB-C connector into the camera base, then secure the cable through the cable hole.

Option 1.

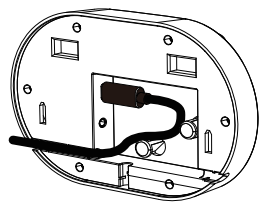

Option 2.

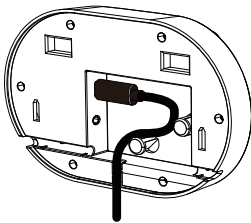

Option 3.

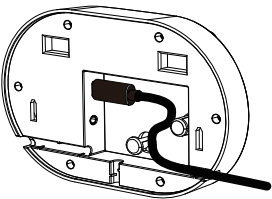

5. Mount the camera base onto the hanging board.

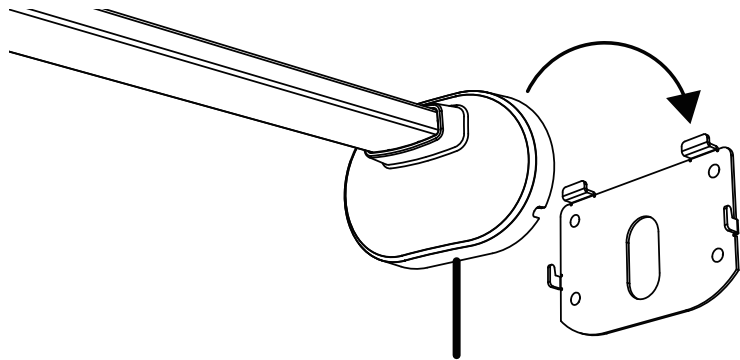

6. Connect the two USB-A connectors to the interactive flat panel.

Note: Both USB-A connectors must be plugged in to provide sufficient power.

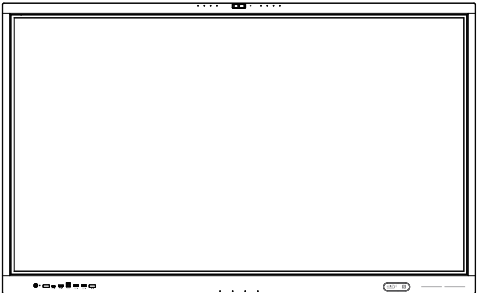
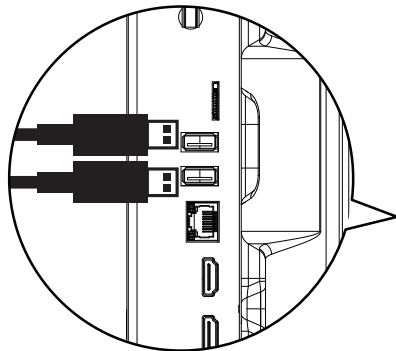

Connections Overview

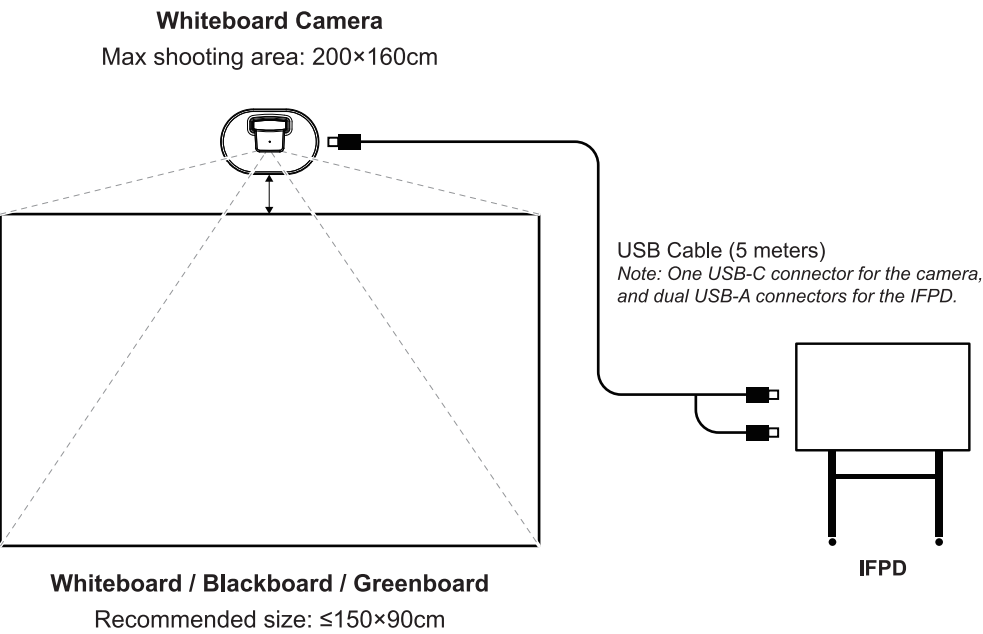

Using the Compatible Software

The whiteboard camera is a standard UVC camera and works with most software that supports UVC video sources, such as Zoom, Microsoft Teams, or Google Meet.

For advanced feature settings, such as whiteboard, blackboard, and greenboard tracking, presenter semi-transparency, and image enhancement, we recommend using our compatible software, available as a free download from our support center:

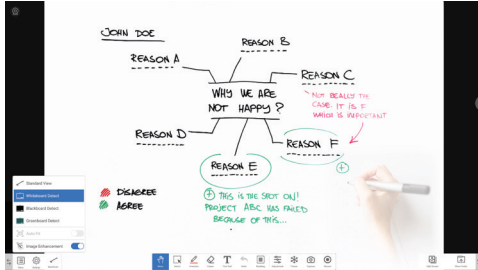

ViiShow App

For live whiteboard demonstrations, compatible with Android & Windows.

Download website:

<https://www.viisan.com/en/download/type4.html>

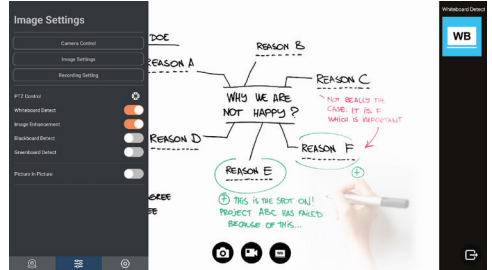

ViiCam App

For configuring camera features on IFPDs, compatible with Android & Windows

Download website:

<https://www.mysheer.com/en/download/type6.html>

Usage Scenario

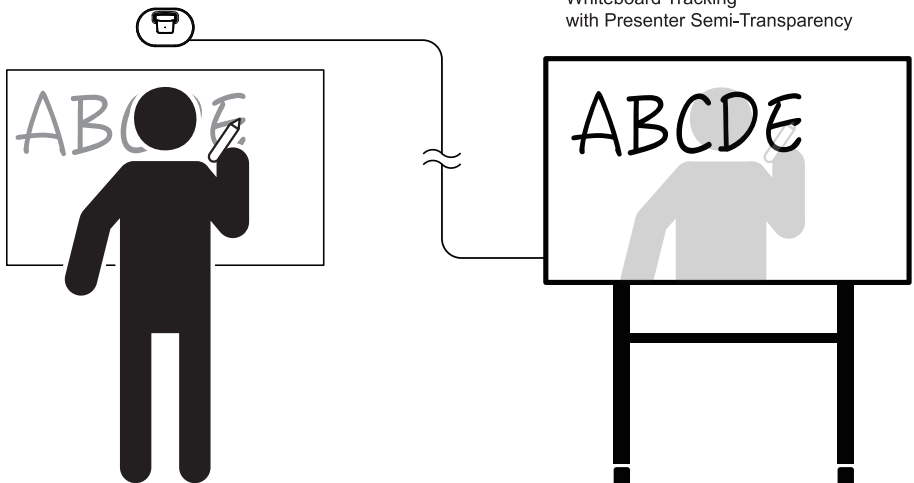

Warranty Information

Warranty Card	
Model No.: VB861A	
This product provides limited warranty continues for one (1) year from the date of purchase.	
Name:	Email:
Address:	
Product S/N:	
Reseller Info.:	
Date of purchase:	

Warranty Exclusions

The following circumstances excluded from warranty coverage:

- Products damage caused by catastrophes, thunder stroke, faulty electric power, and environmental factors.
- Defacing of product labeling(label alterations and falsifying, serial number missing, serial number no longer discernible, serial number invalid). All serial numbers are recorded and tracked for warranty purposes.
- Unauthorized changes of non-parts, modifications or alterations, parts removal in or to the products.
- Damage caused by operator error or operator fails to comply user manual instruction, such as, but not limited to improper storage resulting in product get wet, corrosion, fell off, squeezed or exposed to inadequate temperature/humid environment.
- Accessories or packing material such as boxes, user manual, etc.

VIISAN®

VB861A

白板摄像头
用户指南

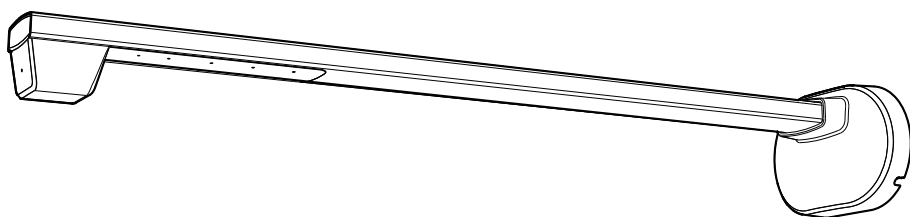

产品说明

感谢您购买 VIISAN 维山产品。

本设备是一款白板摄像头，可通过 USB 连接至交互式智能平板使用，支持白板、黑板和绿板跟踪功能，并具备演示者半透明显示和图像增强等功能。

本快速入门指南将为您简要介绍白板摄像头的使用步骤。若您在使用过程中遇到任何技术或服务问题，请联系 VIISAN 客服团队info@viisan.com，我们将竭诚为您提供支持与帮助。

有限保修

本产品提供有限保修，自购买之日起持续一年。

保修除外责任

- 以下情况不在保修范围内：
- 因灾害、雷击、电力故障和环境因素造成的产品损坏。
 - 产品标签污损（标签涂改和伪造、序列号缺失、序列号无法辨认、序列号无效）。所有序列号均已记录并追踪，以用于保修目的。
 - 未经授权对产品进行非部件的更改、修改或改造，以及拆卸产品中的部件。
 - 因操作失误或未遵守用户手册说明而造成的损坏，包括但不限于不当储存导致产品受潮、腐蚀、脱落、挤压或暴露于不适宜的温度/湿度环境。
 - 配件或包装材料，例如包装盒、用户手册等。

安全与环境信息

- 本设备符合 FCC 规则第 15 部分和 CE 认证。
- 废弃的电气和电子设备可回收，应与生活垃圾分开处理。请将本设备退回收集中心，积极支持节约资源和保护环境。

系统要求



对于 IFPD：ARM Cortex-A55 四核或更高版本
对于台式机或笔记本电脑：Intel® i5 处理器或更高版本
USB 端口：USB 2.0 或更高版本
内存：至少 8 GB RAM（建议 16 GB 或更高）
Android™ 9.0 或更高版本
Microsoft® Windows® 10/11

产品规格

最大分辨率	4K (3840 × 2160) @ 30fps
光圈/焦距	2.6
视场角	150°
色深	24 位
对焦	定焦
支持白板尺寸	最大 200×160 厘米 推荐尺寸：150 × 90 厘米
接口	USB-C 2.0
视频压缩	MJPEG、YUY2, H264、H265
USB 线长	5 米
电源频率	支持 50Hz / 60Hz
供电	5V / 2A (USB-C 2.0 输入，双 USB-A 输出)
尺寸	683.1 (长) x 150 (宽) x 100 (高) 毫米
净重	约 0.52 千克
系统要求	Windows 10/11 Android 9.0 或更高版本

包装内容

使用前，请确保包装内包含以下物品。
如有任何物品缺失，请联系您购买产品的零售商。

- 1. 白板摄像头
- 2. 挂板
- 3. KA3 螺钉 (30 mm × 4) – 用于木质墙壁
- 4. KA3 螺钉 (40 mm × 4) – 用于混凝土墙壁
- 5. 塑料膨胀螺栓 × 4
- 6. USB 数据线 (5 米)
- 7. 安装模板
- 8. 快速入门指南

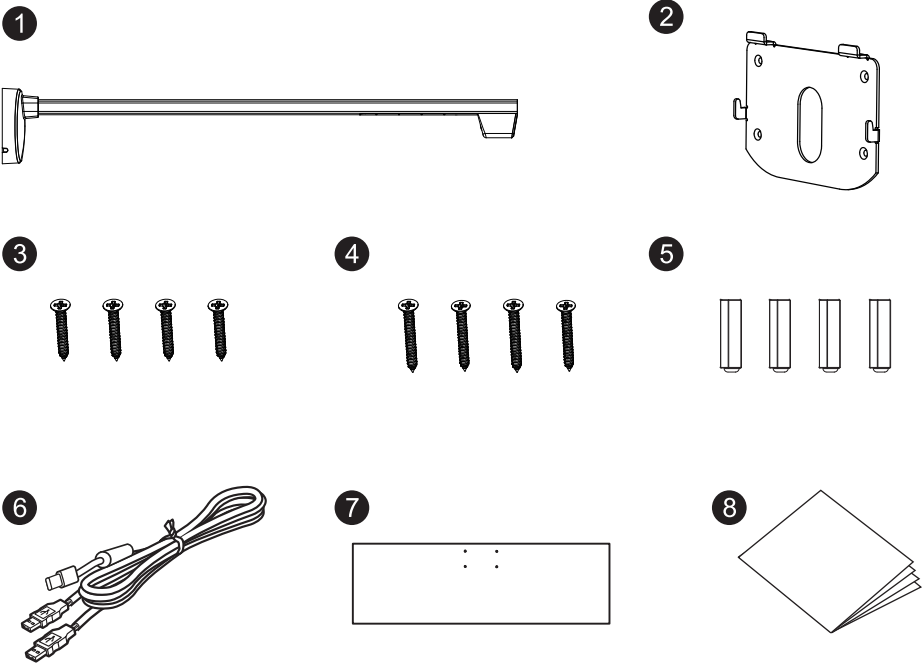

部件描述

1. LED 指示灯
2. 底座
3. 安装槽
4. USB Type-C 接口
5. 走线孔
6. 摄像头

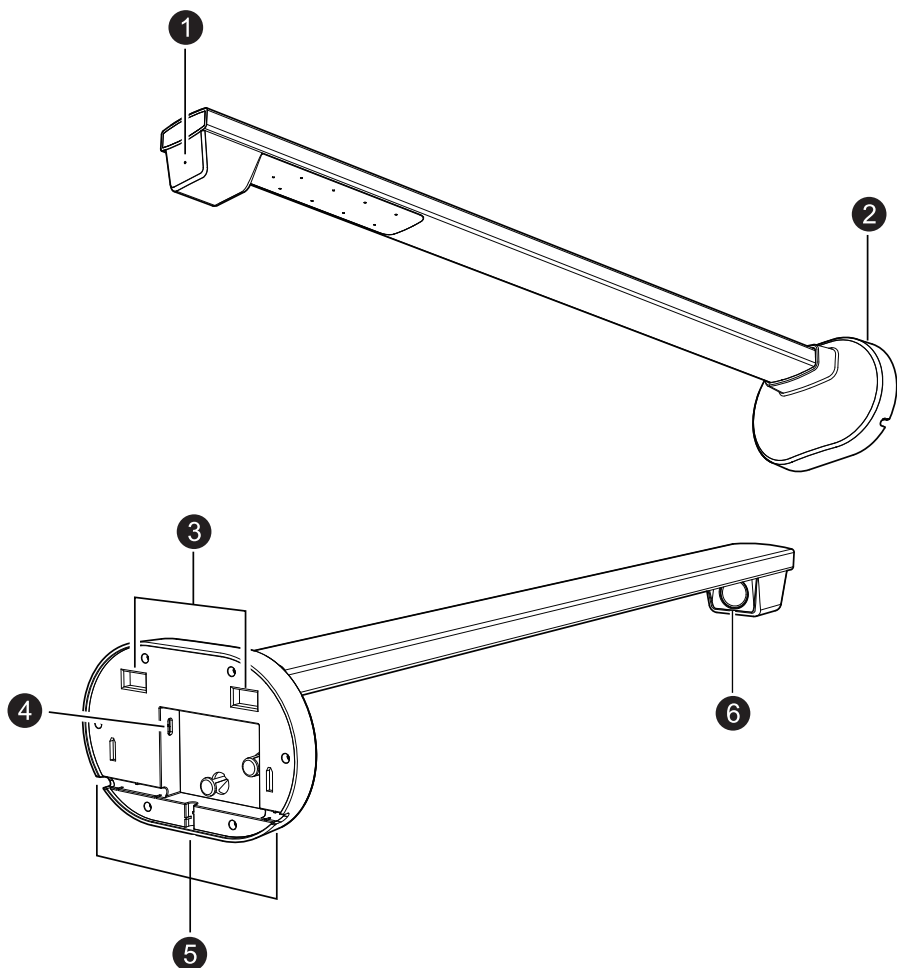

安装步骤

壁挂安装

1. 使用包装中提供的安装模板，将其水平放置在白板的顶部中央，并用铅笔记录螺丝孔位置。

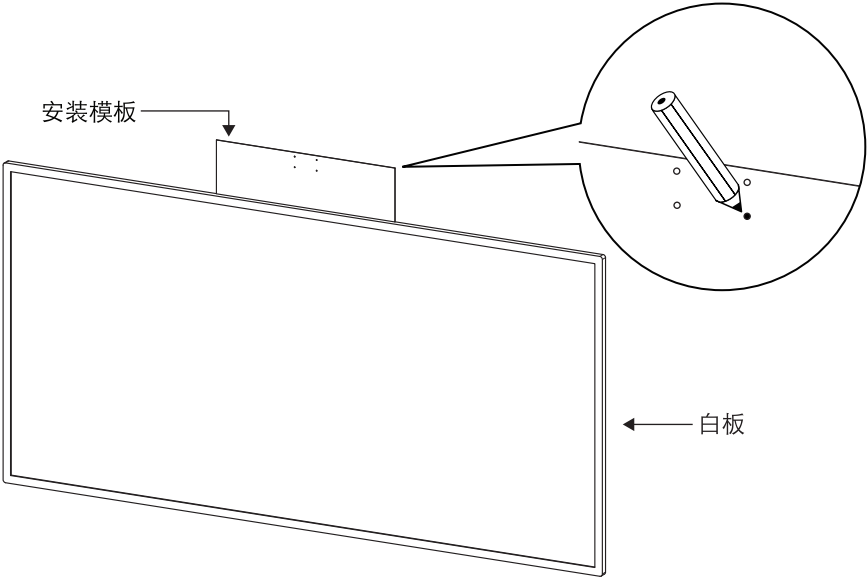

2. 将四个塑料膨胀锚栓插入墙孔，然后拧紧四个 KA3 螺钉。
注意：木墙使用 30 毫米螺钉，混凝土墙使用 40 毫米螺钉。

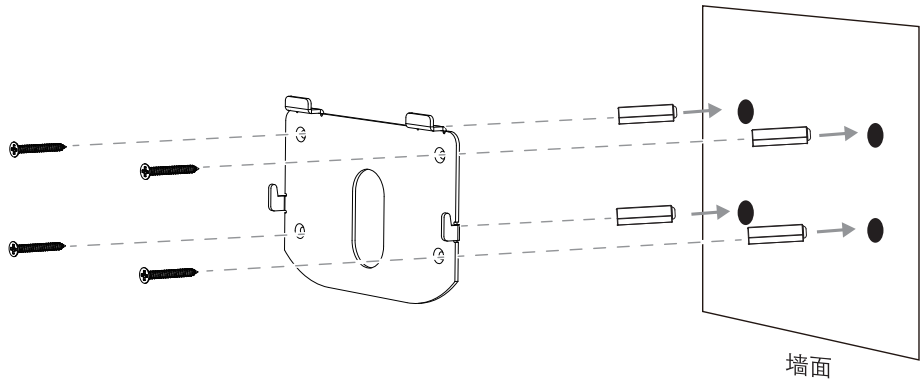

4. 将 USB-C 连接器插入相机底座，然后将线缆穿过线缆孔固定。

选项 1

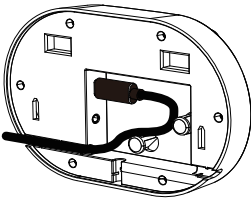

选项 2

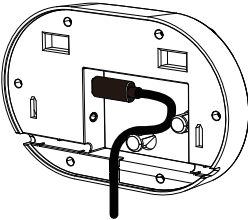

选项 3

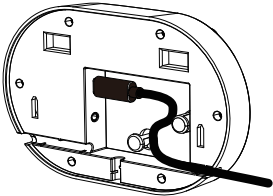

5. 将摄像机底座安装到挂板上。

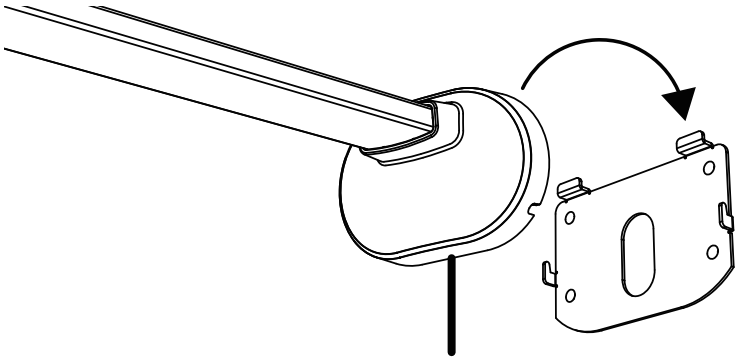

6. 将两个 USB-A 接口连接到交互式平板显示器。

注意：必须插入两个 USB-A 接口才能提供足够的电力。

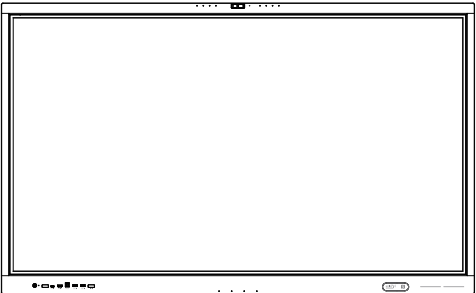
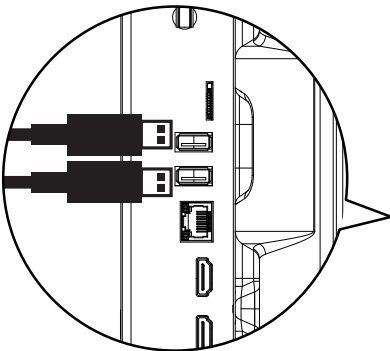

连接概述

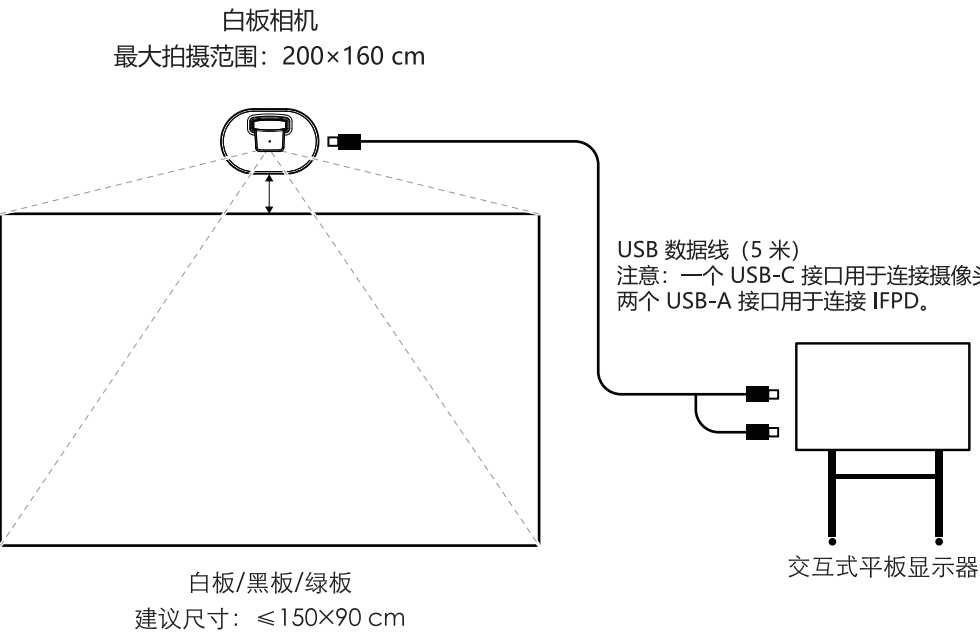

使用白板摄像头和软件

白板摄像头是一款标准的 UVC 摄像头，可兼容大多数支持 UVC 视频源的软件，例如 Zoom、Microsoft Teams 或 Google Meet。

对于白板、黑板和绿板跟踪、演示者半透明以及图像增强等高级功能，我们推荐使用配套的兼容软件，您可从我们的支持中心免费下载：

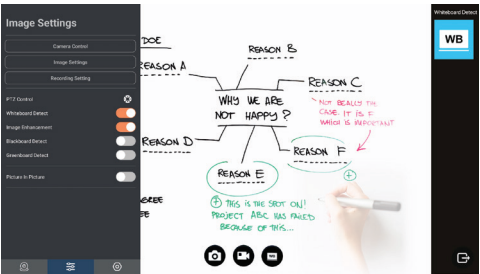
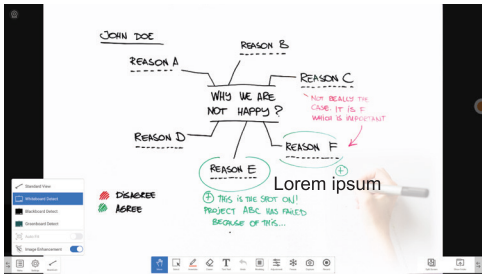

ViiShow应用程序
用于实时白板教学演示，
兼容 Android及Windows。



ViiCam 应用程序
用于在交互式平板上配置摄像头功能，
兼容 Android及Windows。

下载网址
<https://www.viisan.com/en/download/type4.html>

下载网址
<https://www.mysher.com/en/download/type6.html>

应用场景

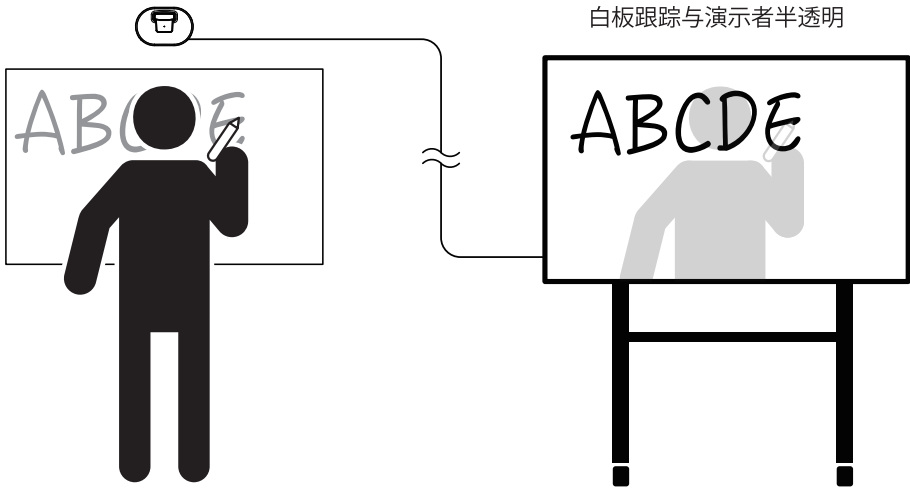

保修信息

保修卡	
型号：VB861A	
本产品提供有限保修，自购买之日起持续一年。	
姓名：	电子邮件：
地址：	
产品序列号：	
经销商信息：	
购买日期：	

保修除外责任

以下情况不属于保修范围：

- 因灾害、雷击、电力故障和环境因素造成的产品损坏。
- 产品标签污损（标签涂改和伪造、序列号缺失、序列号无法辨认、序列号无效）。所有序列号均已记录并追踪，以用于保修目的。
- 未经授权对产品进行非部件的更改、修改或改装，以及拆卸产品部件。
- 因操作失误或操作人员未遵守用户手册说明而造成的损坏，包括但不限于不当储存导致产品受潮、腐蚀、脱落、挤压或暴露于不适宜的温度/湿度环境。
- 配件或包装材料，例如包装盒、用户手册等。